



PRIVATE CHARTERS

IBIZA - FORMENTERA

www.yachtsandboatsibiza.com



SILVER

































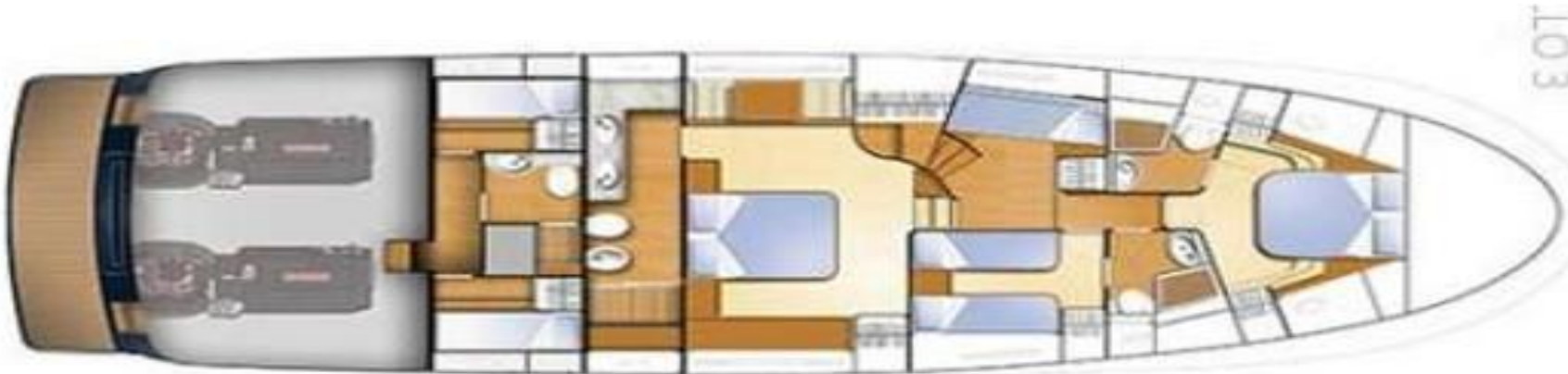

FURNISHING

- A/C
- USB
- Flaps
- GPS
- Bluetooth
- VHF
- Audio system
- Bimini
- Windows 180
- Kitchen
- Int. and Ext. dinning table
- Swim Platform with shower
- Flybridge
- Stabilizers at anchor

ACCOMODATIONS

- 3 + 1 (2 Double Cabins, 1 Twin, 1 children´s cabin)
- 3 Bathrooms

INCLUDED

- Beverage
- Snacks
- Towels
- Paddle Surf
- Snorkel

EXTRAS

- Seabob F5
- 2 x Paddle Board
- Kayak
- Mercury 350 20hp

TECHNICAL DETAILS

Year/Refit:	2009/2020
Lenth / Eslora:	20,16 mts.
Beam / Manga:	5,70 mts.
Engines:	2 x MAN 1100CV
Consumption / Consumo:	220 l/hs.
Capacity / Capacidad:	12+ 2 crew
Overnight/Pernocta:	8
Cruising Speed / Vel. Crucero:	12 knts
Top Speed / Vel. Maxima	

MONTH	DAY	WEEK
May	€3,800.-	€23,000.-
June	€3,800 .-	€23,000 .-
July	€4,300.-	€26,000 .-
August	€4,300.-	€26,000-
September	€3,800.-	€23,000-
October	€3,800.-	€23,000.-

* Included: Insurance, mooring at base port Mahon Menorca..

* Not included: VAT (21%), APA (35%), Fuel, out of mooring.

* Reserves: 50% in Advance.